

Magazie 171

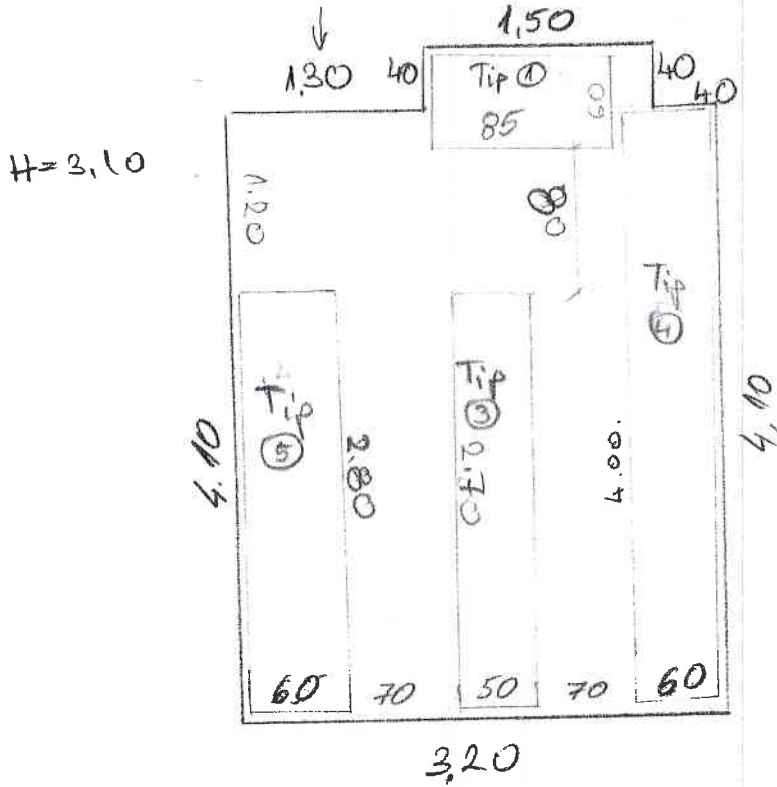

Total:

- Tip ① - 1 buc 85/60/3, 0
- Tip ② - 1 buc 1,30/60/3, 05
- Tip ③ - 2 buc 2,70/60/3, 05
- Tip ④ - 2 buc 4,10/60/3, 05
- Tip ⑤ - 2 buc 2,80/60/3, 05

Magazie 172

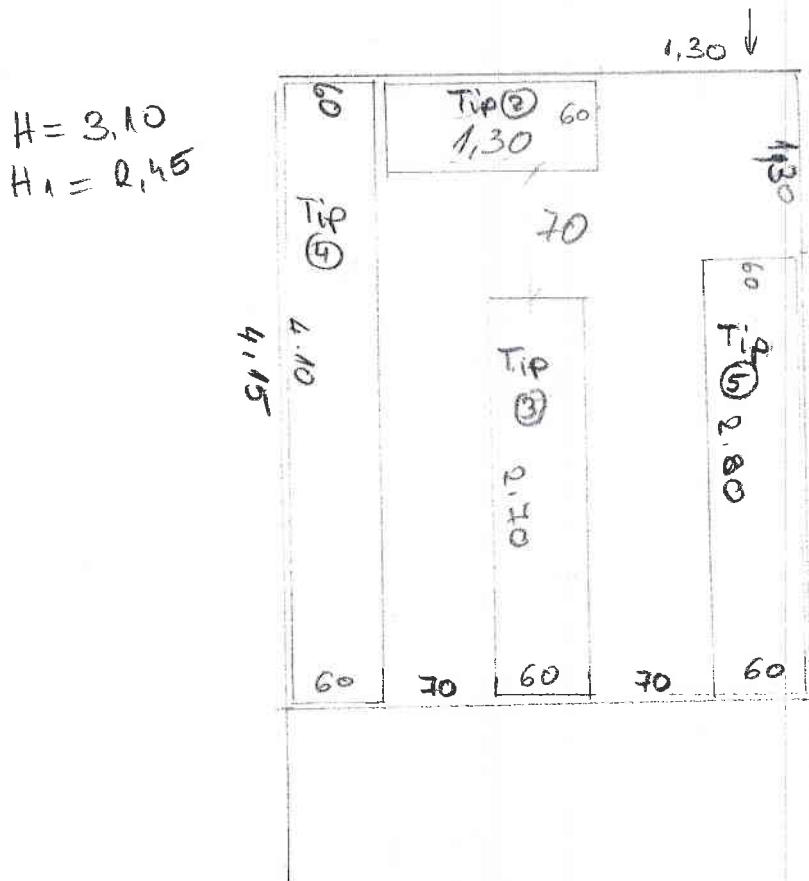

Tip. 1 $l=60\text{cm}$; $L=85\text{cm}$; $H=3,05\text{m}$.

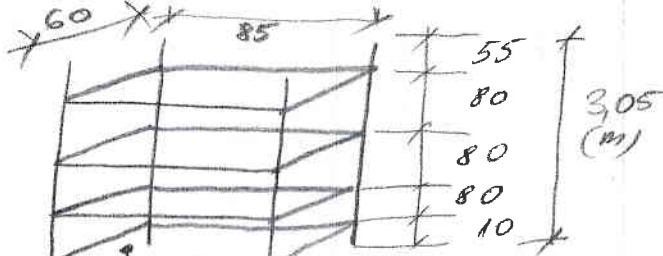

Tv. 40x40x2 (mm)
 cornier 40x40x3 (mm)
 placă OSB 20 mm sau similar

Tip 2 $l=60\text{cm}$; $L=130\text{cm}$; $H=305\text{cm}$

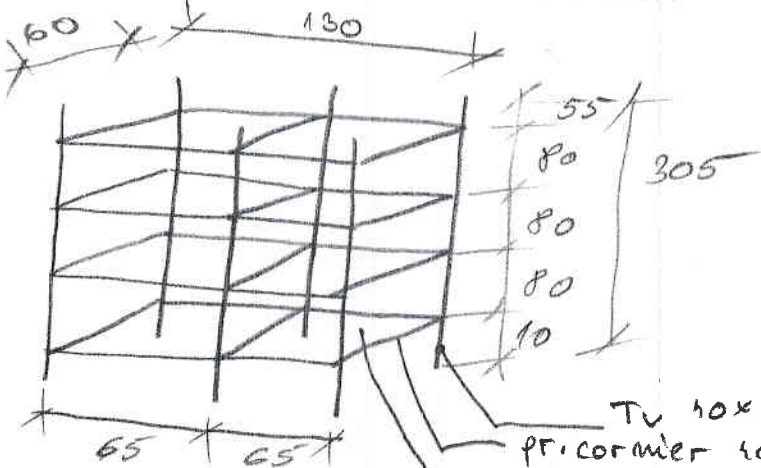

Tv. 40x40x3
 pr. cornier 40x40x3
 placă OSB 20mm sau similar

Tip. 3 $l=60\text{cm}$; $L=270\text{cm}$; $H=305\text{cm}$.

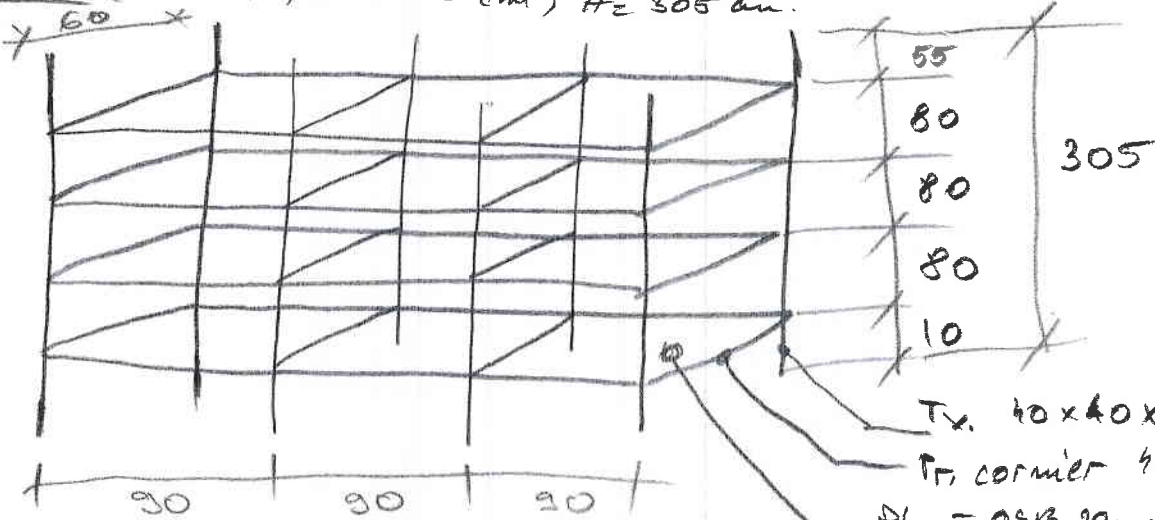

Tv. 40x40x3
 pr. cornier 40x40x3
 placă OSB 20mm sau similar

Tip. 4 $l=60cm; L=410cm; H=305cm$

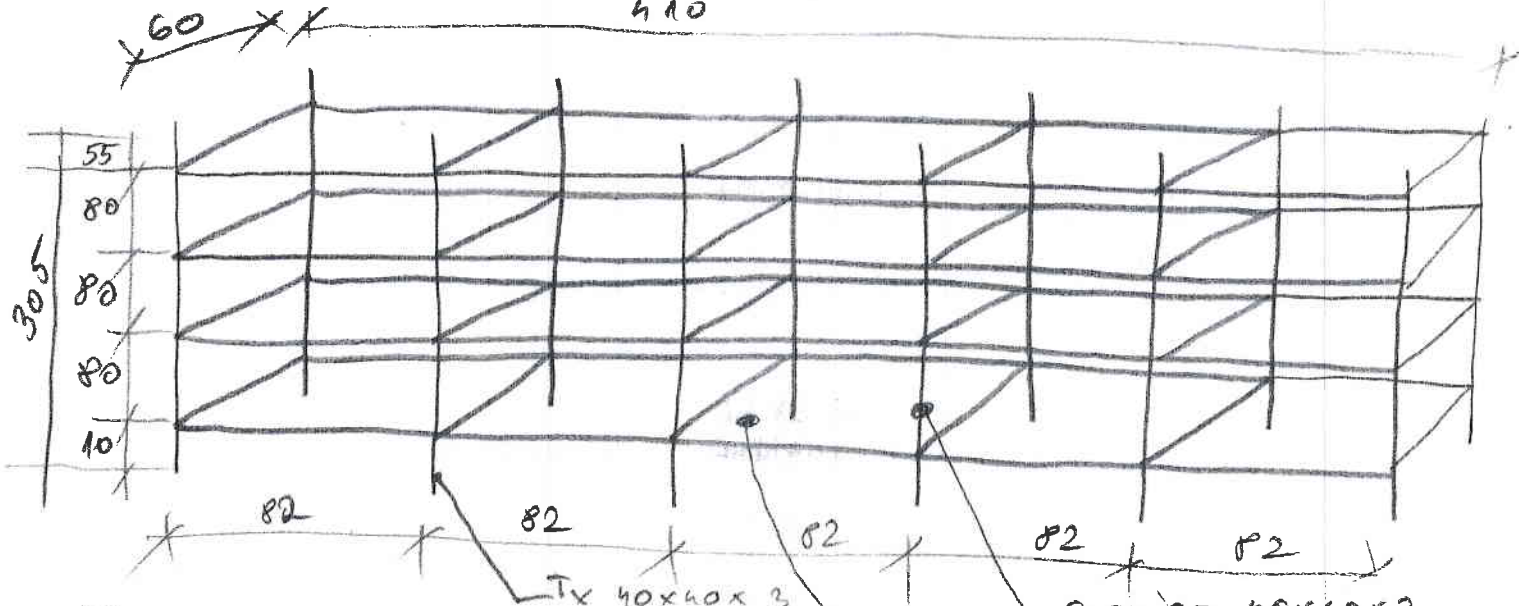

NOTA -> Se imparte in 2 rafturi 2050/3050 x 2 buc

Tip 5 $l=60cm; L=280cm; H=305cm$

